

## Corte 1

Struttura Ricettiva  
Piano Terra

### Edifici Esistenti

Edificio 9	=	157,99 m <sup>2</sup>
Edificio 10	=	71,43 m <sup>2</sup>
Edificio 11	=	295,55 m <sup>2</sup>
Edificio 17	=	258,91 m <sup>2</sup>
Edificio 18	=	355,69 m <sup>2</sup>
Edificio 19	=	256,63 m <sup>2</sup>
Edificio 20	=	40,59 m <sup>2</sup>
<b>Totale</b>	=	<b>1.405,28 m<sup>2</sup></b>

### Porticati Esistenti

Loggiato e	=	87,02 m <sup>2</sup>
Portico m	=	197,66 m <sup>2</sup>
Portico r	=	97,83 m <sup>2</sup>
Portico t	=	22,10 m <sup>2</sup>
Loggiato u	=	23,94 m <sup>2</sup>
Fornice z	=	32,28 m <sup>2</sup>
<b>Totale</b>	=	<b>480,83 m<sup>2</sup></b>

### Pavimentazione Esistente

594,44 m<sup>2</sup>

### Non Costruito

Edifici	=	193,60 m <sup>2</sup>
Porticati	=	73,67 m <sup>2</sup>
<b>Totale</b>	=	<b>267,27 m<sup>2</sup></b>

### Pianta di Riferimento

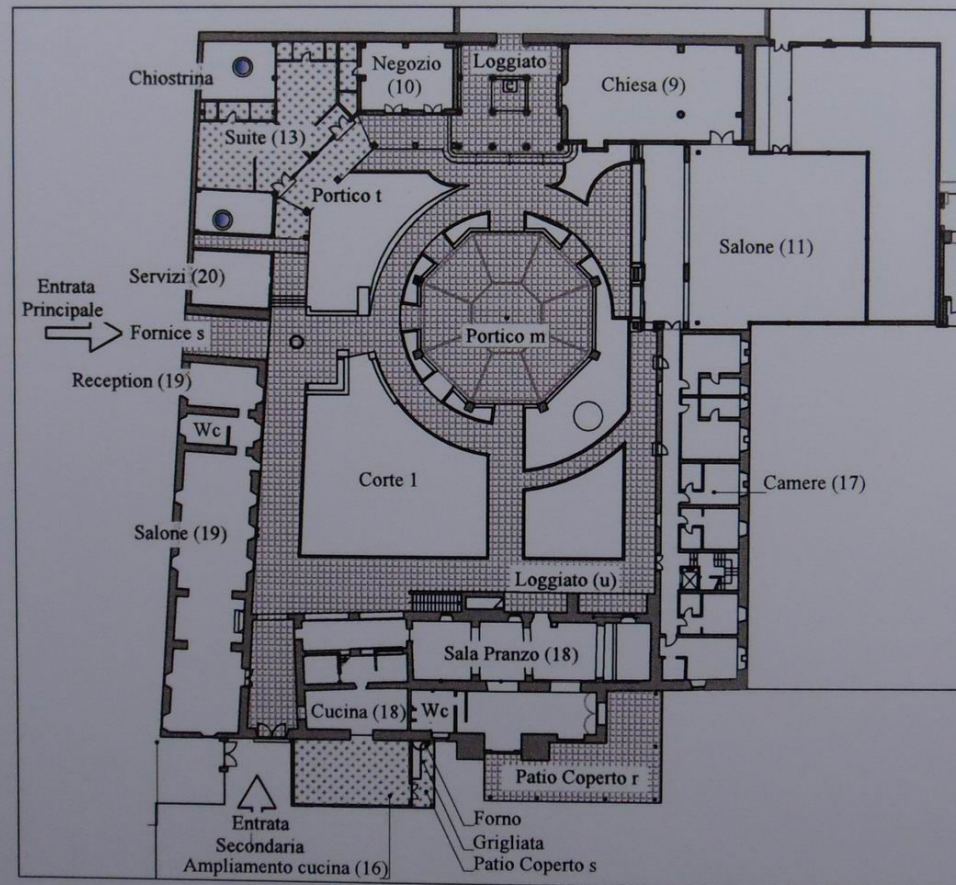
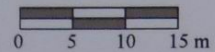
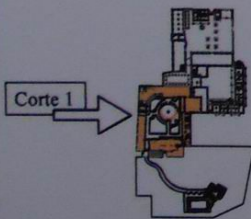

Corte 1 - Piano Terra